





Total Cost of item(s) being purchased: \$45,000.00

Do you have 3 quotes for all items listed above? Yes \_\_\_\_\_ No X \_\_\_\_\_

What is the purpose of each item(s) requested? To shred documents that met their retention period.

If the purchase is to replace item(s) is the item(s) being replaced currently in use?

Yes X \_\_\_\_\_ No \_\_\_\_\_

What is the impact or risk potential if we don't purchase item(s)? Current Shredder no longer supported for maintenance. If it breakdowns no longer would be able to shred documents.

Please Circle Priority: Critical Upgrade Desirable

PRIORITY 1: CRITICAL – Required to prevent a **critical** reduction in service, operating efficiency, economy, and/or safety; to protect valuable property; and/or comply with insurance or code requirements.

PRIORITY 2: UPGRADE – Required for **significant upgrade** in service, operating efficiency, economy and/or safety of current operations.

PRIORITY 3: DESIRABLE – Required to introduce **desirable**, but optional new service, program, faculty or staff, or to make small improvements in operating efficiency, economy and/or safety.

Required with this form:

- Price quotes
- Pictures of item(s) to be replaced
- 5 copies

  
 \_\_\_\_\_  
 Department Head Signature  
 Date: 7/25/2014

\*\*\*\* Please note this form must be filled out in its entirety for purchase to be considered for approval \*\*\*\*

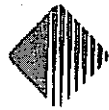

**Allegheny Shredders**

THE SHREDDING INDUSTRY ICON SINCE 1967

March 10, 2014

Ms. Imelda Diaz  
Webb County Records Management  
7209 E. Saunders, Highway 59  
Box 12, Suite 8  
Laredo, TX 78041

Dear Ms. Diaz,

Per our conversation, I'm pleased to submit the following proposal for **your** consideration. I've outlined pricing for two options.

Option 1: New 18-250C

As we discussed, I've shown a trade-in value for your existing 18-250C Shredder toward a new 18-250C 15 Hp. Shredder.

Option 2: Cross-Shredding System

Another option is to position a new 18-250C Shredder in front of your **existing** shredder, at a 90° angle. The shredded material would discharge from the new shredder, **and feed** into the existing shredder. This would give you a Cross-Shredding System. When **utilizing a Cross-Shredding System**, there are two significant advantages: a greater volume of material **can be shredded**, and it increases the level of security because of the much smaller shred size. **The primary shredder's** shred width would be 1", and the secondary shredder's shred width would **be 1/2"**. The result would be a final shred width of approximately 1" x 1/2", as opposed to **your current 1/2"** strip cut. ←

Warranty: Please see Warranty Certificate.

A 50% deposit is required with your order; an additional 40% payment **is due** two weeks prior to shipping, with the remaining balance of 10% due within 15 days. **Please note:** Taxes have not been included in this quotation.

This quote is subject to review after 30 days.

If you have any questions or would like to explore other options, please **give me** a call at (800) 245-2497. We look forward to working with you and to serving **your document** destruction needs for many years to come.

Sincerely,

*Evelyn A. Jefferson*

Evelyn A. Jefferson  
Sales Manager  
[ejefferson@alleghenyshredders.com](mailto:ejefferson@alleghenyshredders.com)

**Webb County Records Management**

March 10, 2014

Page 4 of 5

**Option 2: Cross-Shredding System**

<u>Qty.</u>	<u>Model</u>	<u>Price</u>
1	<b>18-250C 15 Hp. Shredder</b>	\$31,680.
	<b>Capacity</b>	240-250 sheets of 20 lb. bond paper per <b>pass</b> in multiple stacks (actual capacity depends on available power supply).
	<b>Input Speed</b>	80 feet per minute
	<b>Feed Opening</b>	18" wide input conveyor and 7" diameter steel crusher paddle allow shredding of wastebasket contents. Feed opening is protected with a fixed plexiglass safety <b>shield</b> .
	<b>Cutting Assembly</b>	18" wide; 1 3/8" clearance
	<b>Cutters</b>	Sawtooth; precision-ground; heat-treated to optimum Rockwell hardness.
	<b>Shred Width</b>	1"
	<b>Decibel Rating</b>	70 dBA
	<b>Motor</b>	15 Hp., manufactured by Lincoln; TEFC
	<b>Voltage</b>	208 Volt AC, 3-phase, 60 cycle
	<b>Electrical Components</b>	Cutler-Hammer reversing start and controls; low voltage key-locked control panel ensures safe operation by authorized operators only. Current-sensing relay stops the <b>machine</b> in the event of a jam. Reversing starter allows operator to <b>clear</b> jam in seconds. Three (3) two-position stop buttons for <b>additional</b> safety.
	<b>Gear Reducer</b>	Dodge-Reliance shaft-mounted gear reducer; double reduction; 26 to 1 ration; helical gearing – <b>completely</b> sealed and running in oil for quiet, trouble-free operation.
	<b>Bearings</b>	Cutter shafts turn on heavy-duty double <b>spherical</b> roller bearings. Crusher paddle and drive rollers shafts <b>turn on</b> greaseable, sealed, flange-mounted ball bearings. All other <b>shafts</b> turn on sealed ball bearings that require no maintenance.
	<b>Centralized Lubrication System</b>	Offers easy maintenance of spur/drive <b>gears</b> , roller bearings, and outboard bearing.
	<b>Covers and Frame Assembly</b>	Heavy all-steel construction. All covers <b>are</b> securely bolted to prevent unauthorized access.
	<b>Dimensions</b>	59"W x 94"L x 46"H
	<b>Weight</b>	Machine: 2,715 lbs. / Shipping: 3,380 lbs.
	<b>Safety Labels</b>	International symbol-coded safety and <b>warning</b> labels are permanently affixed on the machine to ensure operator's <b>safety</b> awareness.
	<b>Manufactured</b>	Delmont, PA USA
1	<b>Upcharge for 1" Shred Width</b>	540.
1	<b>Upcharge for 208V</b>	630.
1	<b>Impact-Resistant T-18 Tool Steel Cutters</b>	880.
	This special steel withstands the heaviest shock loads and the most abusive applications, essentially eliminating 90% of cutter <b>breakage</b> .	
1	<b>Transfer Conveyor (20"W x 6'L)</b>	5,450.

**Equipment Total: \$39,180.**

**Webb County Records Management**

March 10, 2014

Page 5 of 5

All prices are F.O.B. Delmont, PA

Estimated Shipping\*: \$1,780.

Crating: \$750.

**\*IMPORTANT:** The charges shown above are *estimates*. Customer is responsible for the *actual* charges incurred for Shipping.

**Option 2 - Estimated System Total: \$41,710.**

*Shipping excludes off-loading, equipment placement, and electrical hook-up. In addition, Customer is responsible for providing a forklift and qualified driver for equipment assembly.*

*This system is not equipped with reduced voltage starting. It is the responsibility of the buyer to determine if a third party inspection, such as UL or CSA, is required. If so, it is the responsibility of the buyer to make arrangements for the inspection and pay any associated costs.*

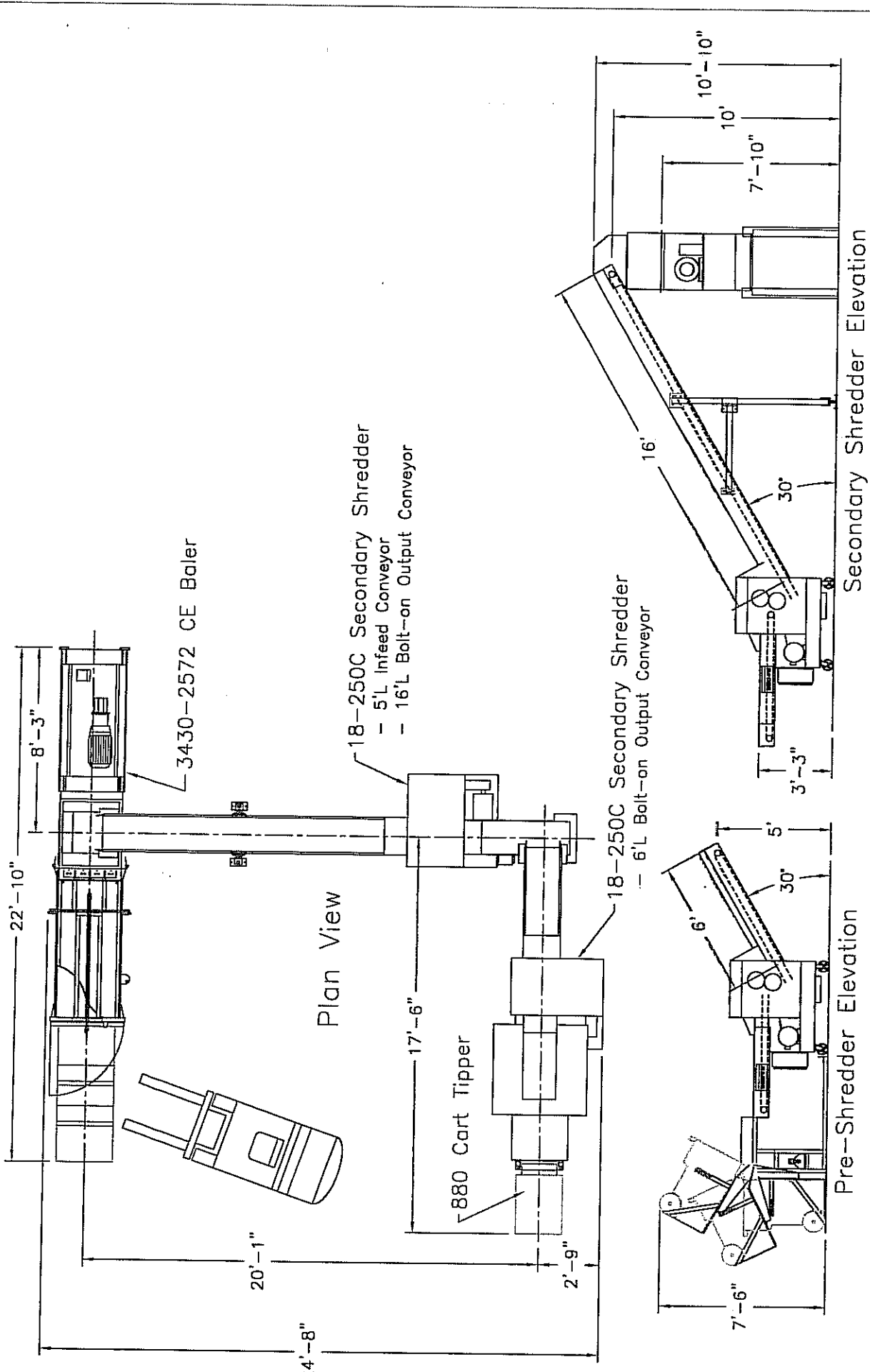

<b>ALLEGHENY PAPER SHREDDERS CORPORATION</b>			
This drawing is the property of and includes proprietary information belonging to Allegheny Paper Shredders Corporation and should not be shown to others without the express written permission of Allegheny Paper Shredders Corporation. All rights of design or invention are reserved.			
UNLESS OTHERWISE SPECIFIED DIMENSIONS ARE IN INCHES TOLERANCES ARE			
FRAC	DECIMALS	ANGLES	DATE
-	.XX	-	3/4/08
-	.XXX	-	DRAWN: TAW
PART #	MODEL	18 Cross-Shred	
PD\18-250C\0395	18-250C	Cross-Shred, 3430	

This conceptual drawing shows approximate dimensions only. Actual dimensions may vary.

