

**PERMIT TO CONDUCT GEOPHYSICAL OPERATIONS ("PERMIT")**

Webb County School Land  
1000 Houston Street  
Laredo, Texas 78040

**Prospect: Lewis Energy- Owen**  
**Permit No.: 101**  
**Date: 3-24-2015**

RE: Mineral Permit

Dear Mr. Ray Rodriguez

**MicroSeismic, Inc.** ("MSI") and/or its assigns, hereby respectfully requests your permission to conduct a geophysical survey (2-D type), including the right of ingress and egress for such purposes across the mineral (oil and gas) interests owned or leased by you in Webb Counties, TX, more fully described below. The purposes of the survey are to acquire 2D seismic data for research purposes in development of a new imaging technique and are non-commercial in nature. Any imaging will be strictly limited to the area directly associated with the wellbores that are being stimulated in association with this project.

**Legal Description (hereafter called the "Lands"):**

AS WELL AS ANY MINERAL POSITION Webb County School Land **MAY HAVE OR ACQUIRE WITHIN THE BOUNDARIES OF THE MSI 2D, THAT MSI MAY BE UNAWARE OF AT THIS TIME AS DEPICTED ON THE ATTACHED PLAT(S): "Company" MAKES NO REPRESENTATIONS OR WARRANTIES WITH RESPECT TO OWNERSHIP OF ITS INTEREST.**

MSI's operations on the Lands will be conducted in accordance with standard industry practices and in a prudent and careful manner. MSI agrees to indemnify and hold you harmless from any and all claims, liabilities, losses, damages, or judgments (if any) arising out of any operations of MSI, and / or MSI's agents, servants, employees, or independent contractors, collectively "MSI Group" which are caused by MSI operations, negligence, misconduct, or failure to exercise due care. For this seismic survey it is our intention to include under this Permit any surface and mineral (oil and gas) interests (where your interest is in the minerals/oil and gas) owned by you but that we may not be aware of at this time lying within the boundaries of this survey.

This Permit shall survive any lease, sale, trade, assignment or conveyance of the Lands made after the Effective Date of this Permit, as listed below, and will be binding on your successors or assigns.

Please sign this Permit in the space provided below, return one copy of this Permit to our office in the enclosed courtesy envelope and retain the other copy for your records. Please add your phone number if it is not already indicated below.

Thank you for your time and consideration.

Sincerely,

This Permit should be returned to:  
MicroSeismic, Inc.  
10777 Westheimer, Suite "500"  
Houston, TX 77042  
Attn: Jake Fadeley, Agent  
Office Phone No.: (713) 781-2323  
Mobile Phone No.: (713) 304-3044  
Email: hjfad@aol.com

  
\_\_\_\_\_  
Jake Fadeley, Mineral Permit Agent

Permission Granted By: \_\_\_\_\_

Effective Date: \_\_\_\_\_, 2015

Owner Phone#: ( \_\_\_\_ ) - \_\_\_\_ - \_\_\_\_ Cell#: ( \_\_\_\_ ) - \_\_\_\_ - \_\_\_\_

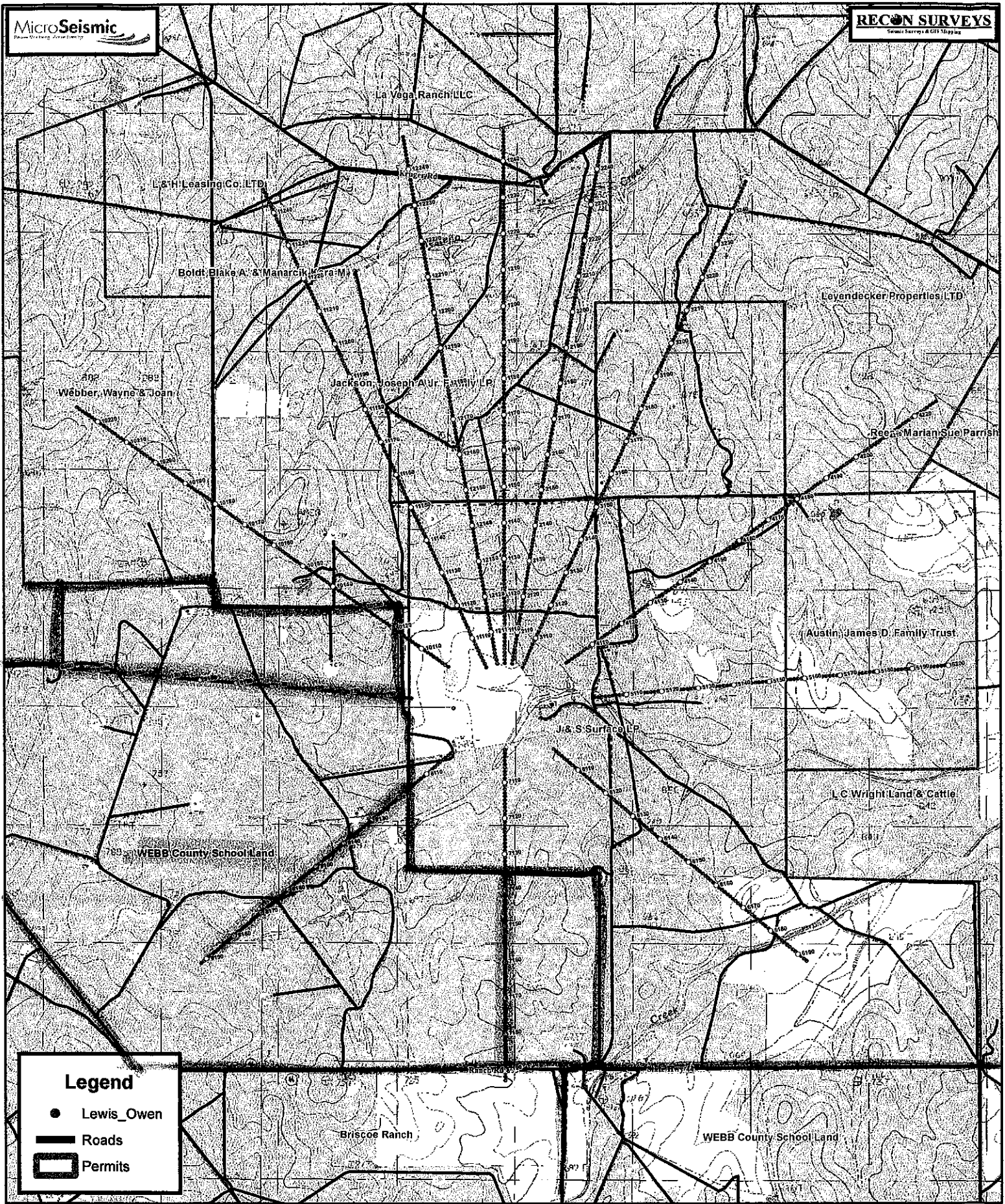

**Legend**

- Lewis\_Owen
- Roads
- ▭ Permits

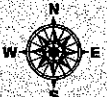

0 950 1,900 3,800 5,700  
Feet  
NAD\_1927\_StatePlane\_Texas\_South\_FIPS\_4205

**Webb Co., TX**  
**Lewis- Owens Unit Fracstar Design**  
**1481 Total Stations @ 100 Ft. Spacing**  
**March 16, 2015**



Recon Surveys L.L.C.  
ArcGIS 10.1 Development Team  
Created By C.S. Map Size: 8.5X11